

Journey Unifit

Rack Installation Guide

INFINITEALUM[®]
Recycled Aluminum



HARDWARE

- 4 x 4 mm Allen Bolts
- Heavy duty center bracket can attach to a brake caliper or fender bridge
- Extra-long Versalock™ arms for frames with eyelets.
- Includes two sets of adjustable feet to customize height and setback position

4X

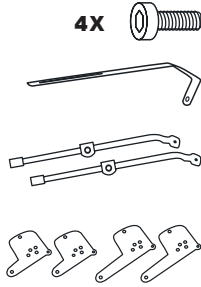

Other mounting options (sold separately):

Trek® Seat Collar

- 28.6 mm: 255120-01
- 29.8 mm: 255120-02
- 31.8 mm: 255120-03
- 34.9 mm: 255120-04



COMPATIBILITY

- Fits wheel sizes: 26 in., 27 in., 27.5 in., 28 in., 29 in., 700c
- Disc brake compatible
- Quick-release skewer compatible

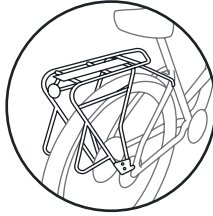

TOOLS REQUIRED

4 mm Allen wrench



5 mm Allen wrench



8 mm open wrench or ratchet

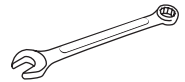

1 Mount the lower part of the rack:

- Determine which of the adjustable feet to use with the size and shape of your bike – each of the feet have indication on the holes for recommendation based on wheel size
- Attach the foot to the frame of the rack using a 4 mm Allen wrench and ratchet with the nuts and bolts provided.

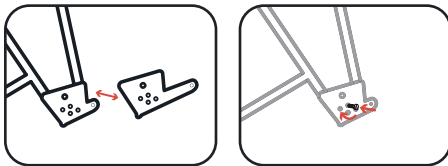

1A - QUICK RELEASE SKEWER:

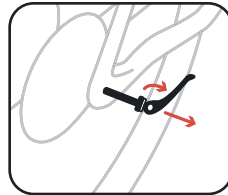

- Release your quick release skewer, without removing your wheel.

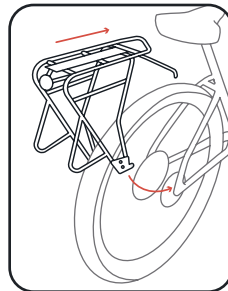

- Ensure the rack is facing forward, with the two bolts on the top of the rack closest to your seat.
- Place each of the sweepback feet on the outside of your frame so that the holes align with the holes in the axle.

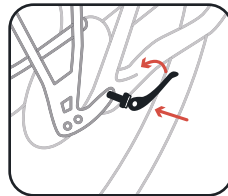

- Replace your quick release skewer and tighten to secure.

1B - MOUNTING BOLTS:

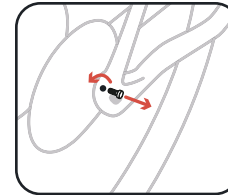

- Remove the bolts in the eyelets just above your axle on the seat stay.

If there are no bolts, ensure the eyelets are clear, and the threads are free of debris – you can do this by screwing in one of the 4 mm Allen bolts provided with your rack. The bolt should go in and out of the frame smoothly.

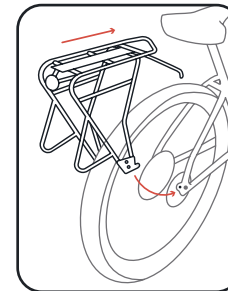

- Ensure the rack is facing forward, with the two bolts on the top of the rack closest to your seat.
- Place each of the sweepback feet on the outside of your frame so that the holes align with the holes in the axle.

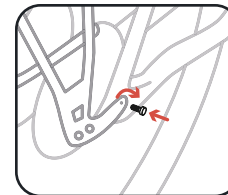

- Use two of the 4 mm bolts to secure the sweepback feet to the frame – do not tighten fully.

2 Mount the upper part of your rack:

2A - SEAT STAY EYELETS:

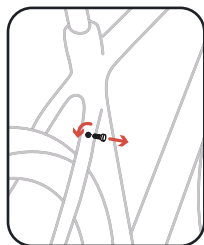

- Remove the bolts at the top of the rear seat stays from the eyelets either side of the frame.

If there are no bolts, ensure the eyelets are clear, and the threads are free of debris – you can do this by screwing in one of the 4 mm Allen bolts provided with your rack. The bolt should go in and out of the frame smoothly.

- Attach the Versalock™ arms to the holes at the front end of the rack by screwing the 5 mm bolts into the plastic bracket pieces provided, do not tighten – the arms should be able to move freely

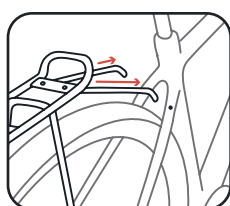
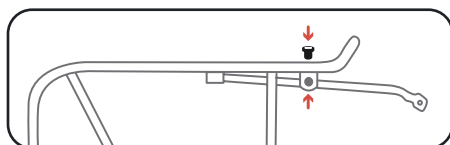

- Reach the arms forward to the seat stay eyelets. The arms may reach better with the 90° angle pointing toward the inside or outside of the frame, either way will work.

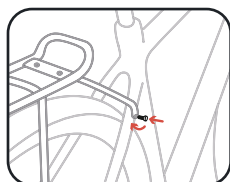

- Attach the Versalock arms to your frame using the 4 mm bolts provided with your rack, do not tighten them fully.

- Adjust the angle of the rack by sliding it back and forth on the Versalock arms, the rack should sit level or tilted slightly forward, ensuring the platform does not lean to the rear.

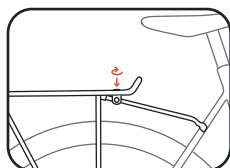
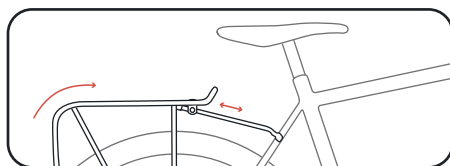

- Secure the rack's positioning by tightening the top 5 mm bolts to tighten the Versalock arms in place

*Pro Tip: For a custom fit, you can round the Versalock arms up to 30° without impacting their strength.

2B - CENTER BRACKET TO BRAKE CALIPER OR FENDER BRIDGE:

- Attach the extension arm by using the two bolt holes in the center on the front end of the rack with a bolt, washer and nut in each hole. Do not tighten it all the way so that the extension arm can slide back and forth.

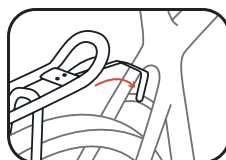
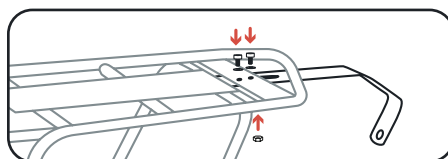

- Extend the extension arm forward to reach the attachment point – the arm may need to be bent so that it can follow the curve of the wheel and the rack sits level.

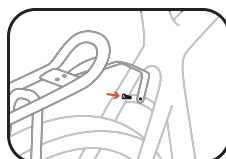

- Secure the rack by using the appropriate bolts to attach to the brake caliper, or fender bridge

- Level the top plane of the rack by sliding it forward and back on the extension arm

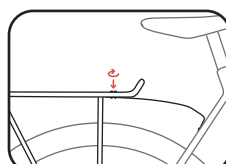
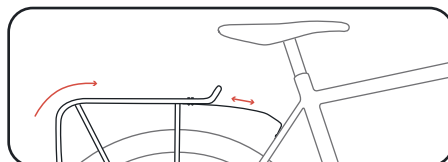

- Tighten the bolts in the center on the rack to secure the length of the extension arm

2C - TREKK SEAT COLLAR EYELETS:

TREKK SEAT COLLAR REQUIRED

Sold separately to create eyelets next to the seat post on bikes without them.

AVAILABLE FOR SEAT POST SIZES:

- 28.6 MM
- 29.8 MM

- 31.8 MM
- 34.9 MM

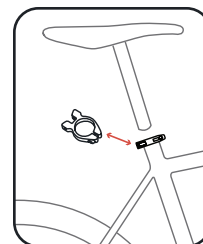

- Remove your bike's current seat collar by loosening the bolts at the base of the seat post, pull up to remove the seat.
- Replace with the new collar with the eyelets to the back and tightening bolt to the front. Insert the seat post back into the required height and tighten securely.

- Attach the Versalock™ arms to the holes at the front end of the rack by screwing the 5 mm bolts into the plastic bracket pieces provided, do not tighten – the arms should be able to move freely

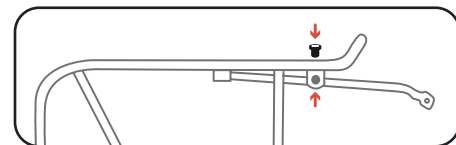

- Reach the arms forward to the seat collar eyelets. The arms may reach better with the 90° angle pointing toward the inside or outside of the frame, either way will work.

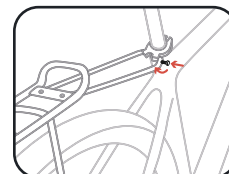

- Attach the Versalock arms to the collar using the 4 mm bolts provided with your rack, do not tighten fully.

- Adjust the angle of the rack by sliding it back and forth on the Versalock arms, the rack should sit level or tilted slightly forward, ensuring the platform does not lean to the rear.

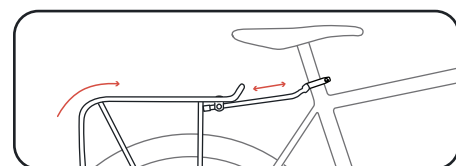

- Secure the rack's positioning by tightening the top 5 mm bolts to tighten the Versalock arms in place

3 Tighten all of your bolts and get ready to ride. Check out other products on axiomgear.com to get the gear that suits your lifestyle and go ride free!

WARNING Failure to follow installation instructions can result in loss of control, damage, personal injury or death. Axiom Cycling Gear recommends that all racks are installed by a qualified bicycle mechanic. -

Periodically check all nuts and bolts for tightness.

WARRANTY & CUSTOMER SERVICE

Our entire product line is made from reclaimed and recycled materials. We ensure our products are ethically produced by trusted partners who are like family. Quality products with a lifetime warranty because product made to last means less waste.

For any questions and concerns you may have about your Axiom products, please contact us on our website at www.axiomgear.com/contact-us